

# Hortense Essentiel

## USER MANUAL

Before any use, it is imperative to read and follow all the instructions below.

A Chinese proverb says:  
Happy for an hour? Drink a glass.  
Happy for a day? Get married.  
Happy for life? Become a gardener.

### CDS Boutique

4118, Industriel Blvd,  
Sherbrooke (Qc) J1L 2S6

Tel. 819 340-1193 or  
Toll-free 1 888 907-6878  
Fax 819 340-1195 or  
Toll-free 1 888 515-6879

[info@cdsboutique.com](mailto:info@cdsboutique.com)

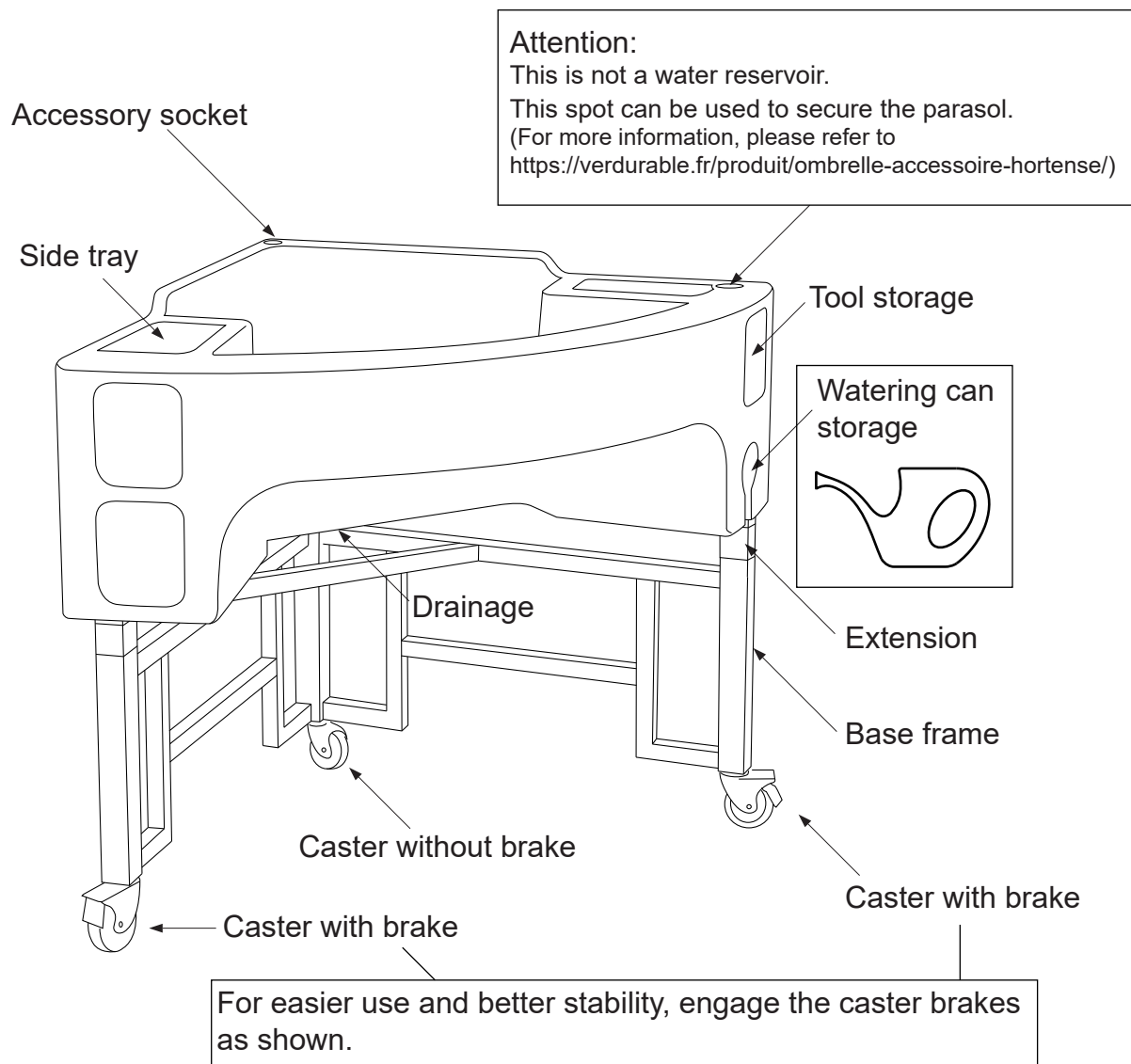

**Assembly guide video** and other digital documents  
available at [www.verdurable.fr/cdsboutique](http://www.verdurable.fr/cdsboutique)  
or via the QR code.

## Parts and accessories list

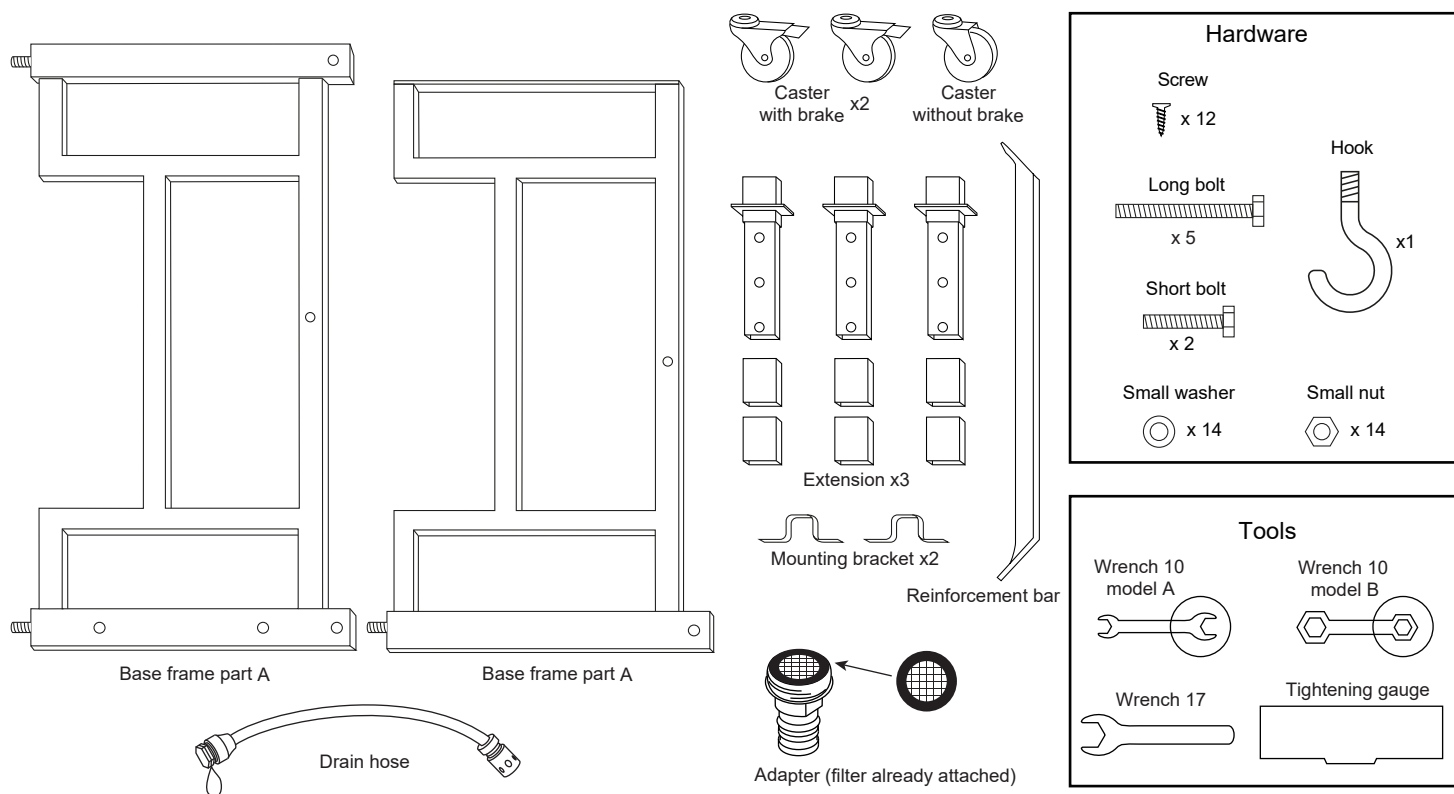

## Installation Step 1

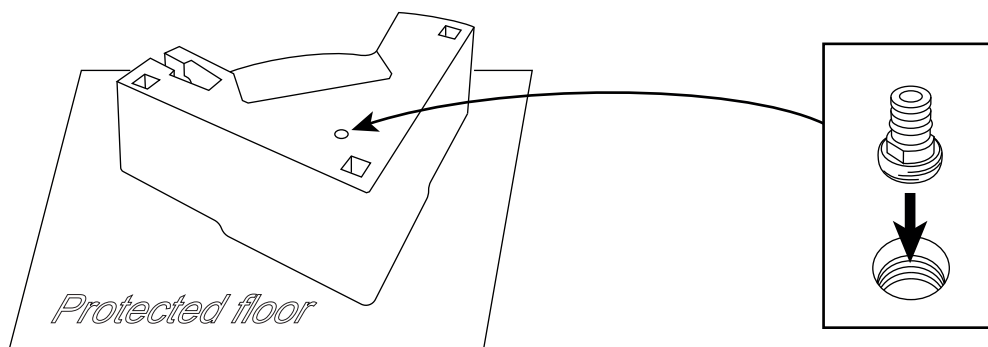

1.1) Place the tub upside down.

1.2) Insert the adapter into the drainage hole, ensuring it is upright and not tilted.

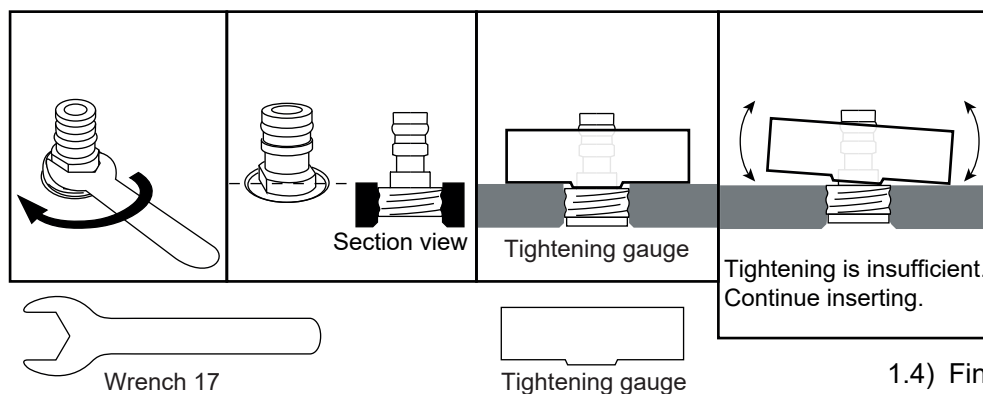

1.3) Insert the adapter into the drainage hole using the wrench 17. The threaded part coated with PTFE tape must be inserted into the hole. Regularly use the tightening gauge to check the insertion depth.

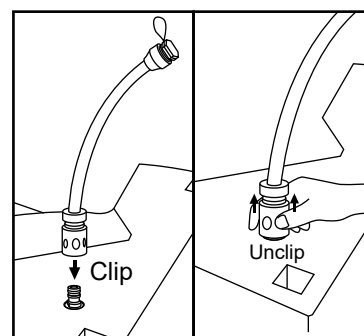

1.4) Final check:  
Clip the drain hose connector onto the adapter. If it stays securely in place without coming off (i.e., without being unclipped), the adapter is correctly installed.  
If the hose connector comes off the adapter without being unclipped, slightly pull the adapter out of the hole using the wrench 17.

## Installation Step 2

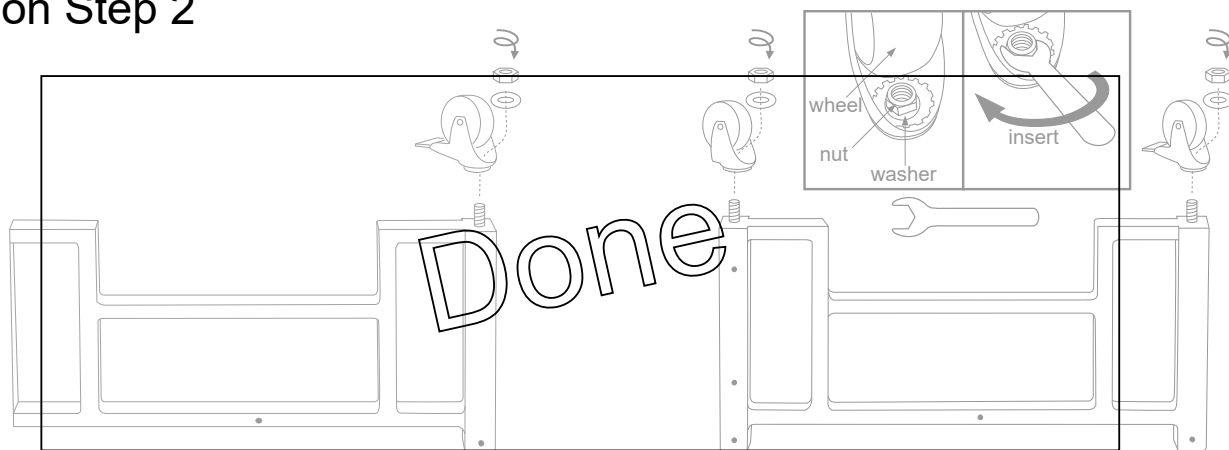

2.1) Install the casters (already done).

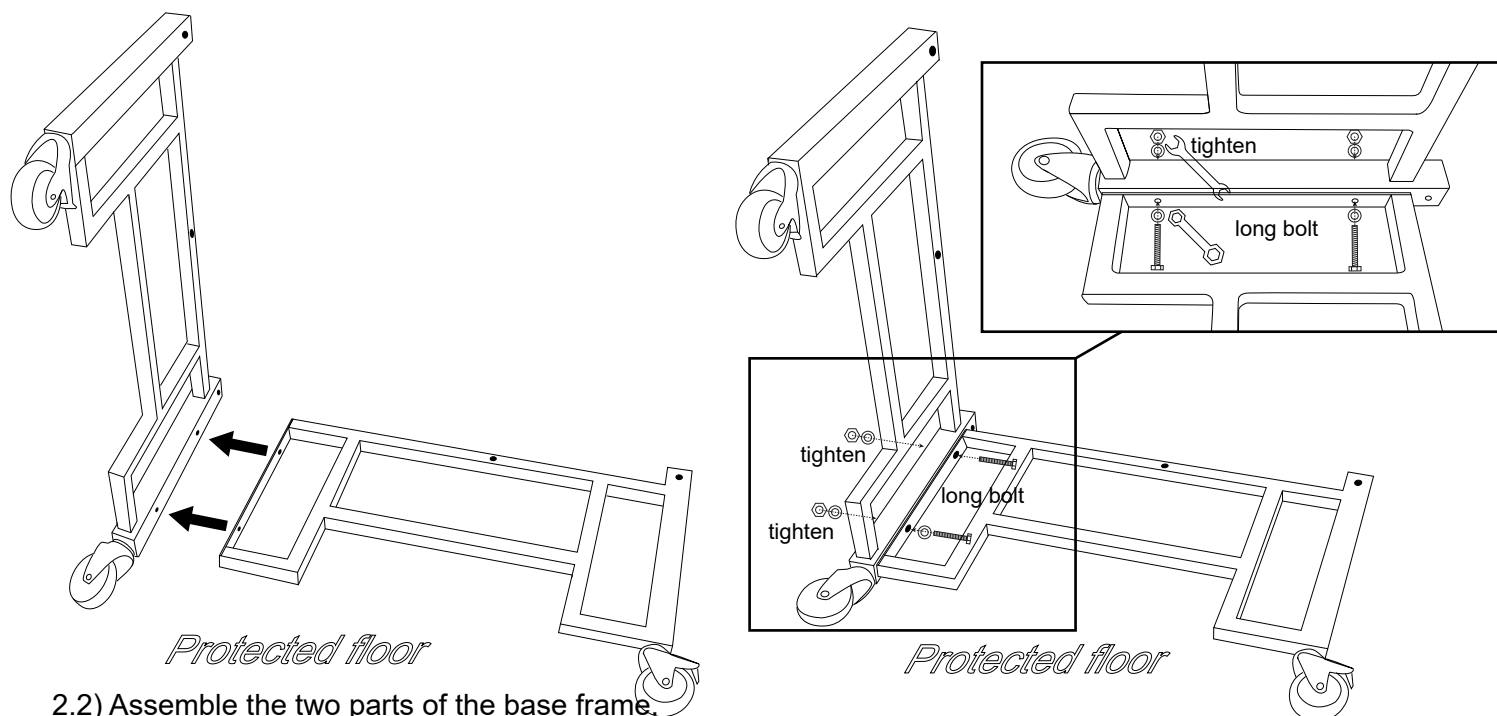

2.2) Assemble the two parts of the base frame.

Required accessories: long bolts, small nuts, small washers, wrenches 10.

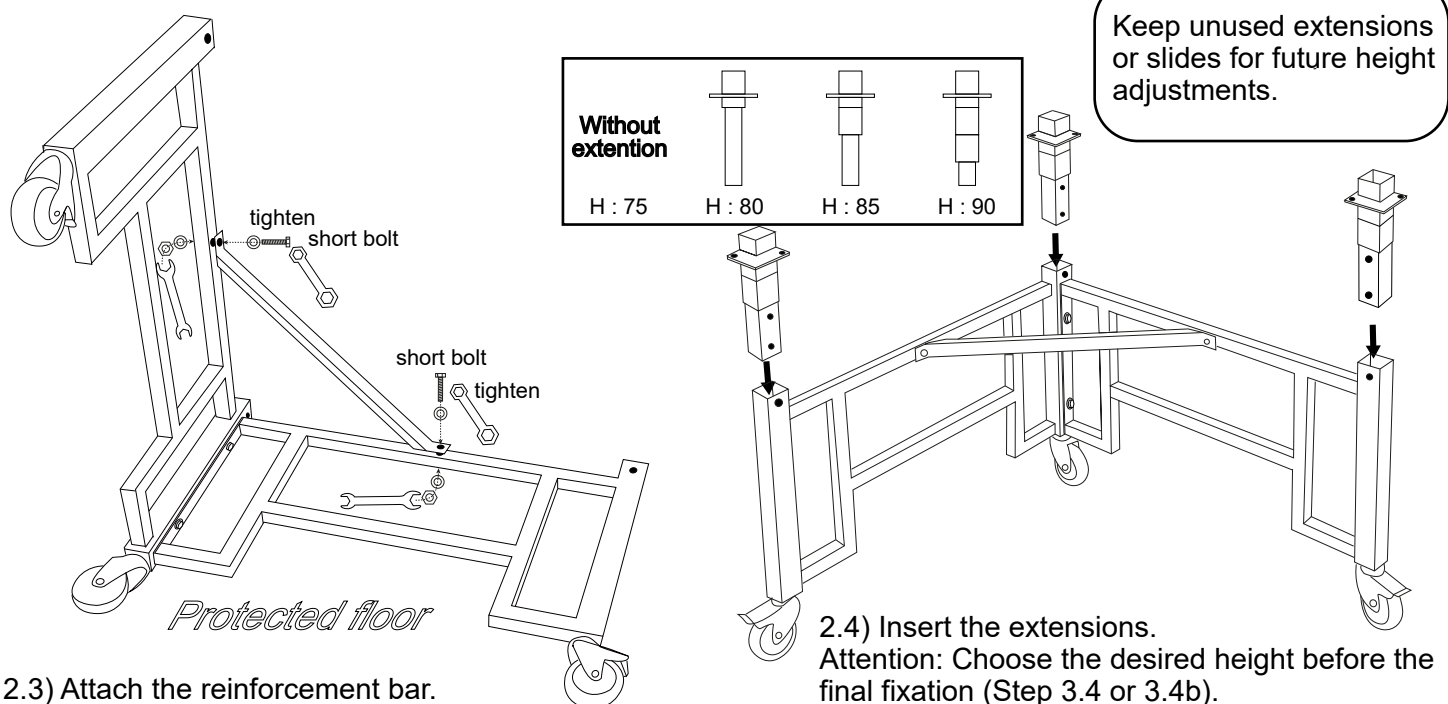

2.3) Attach the reinforcement bar.

Required accessories: short bolts, small nuts, small washers, wrenches 10.

2.4) Insert the extensions.

Attention: Choose the desired height before the final fixation (Step 3.4 or 3.4b).

For nursing home or disability group home (**LTC or SRF**), it is recommended to start at a height of 85 cm for testing.

For **Elementary school**, it is recommended to start at a height of 75 cm.

## Installation Step 3

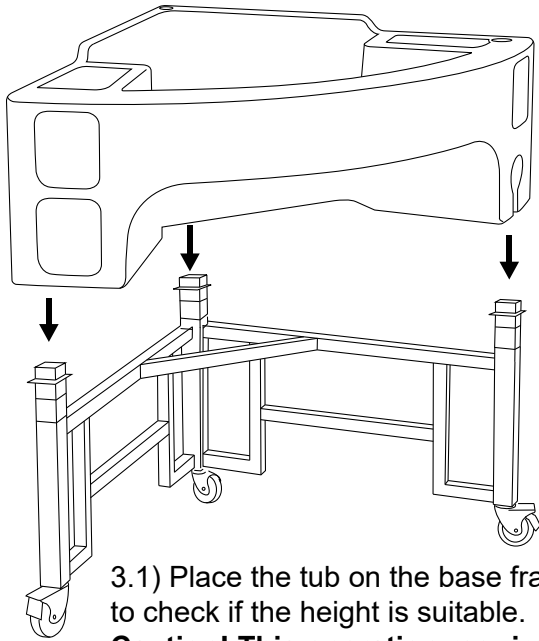

3.1) Place the tub on the base frame to check if the height is suitable.  
**Caution! This operation requires 2 persons.**

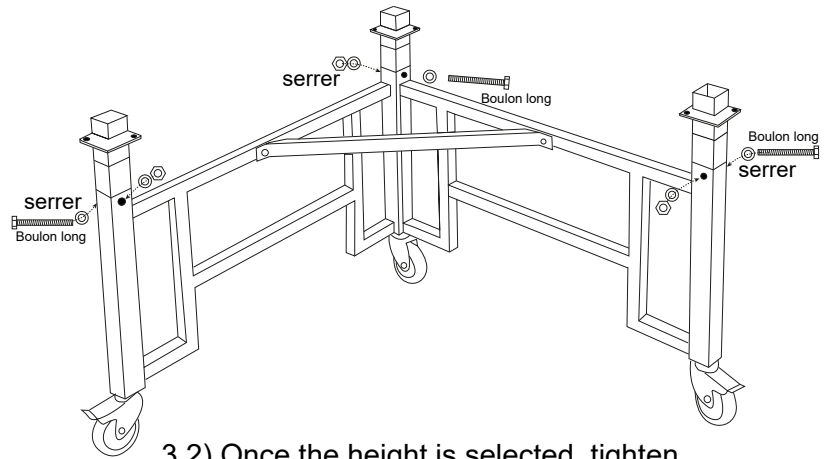

3.2) Once the height is selected, tighten the extensions onto the base frame (for heights of **80 cm, 85 cm, and 90 cm**). For a height of 75 cm, see Step 3.7b. Required accessories: long bolts, small nuts, small washers, wrenches 10.

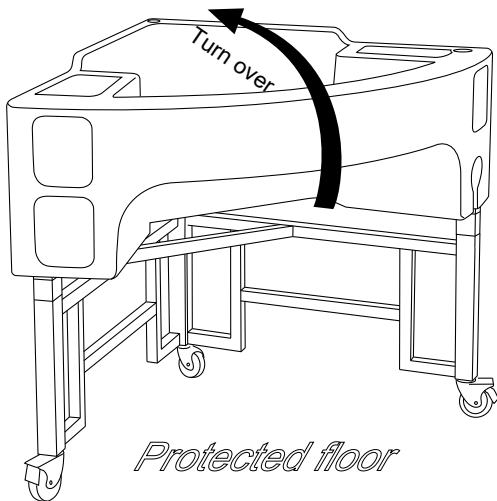

3.3) Turn the planter upside down while keeping the tub and base frame assembled.  
**Caution! This operation requires 2 persons.**

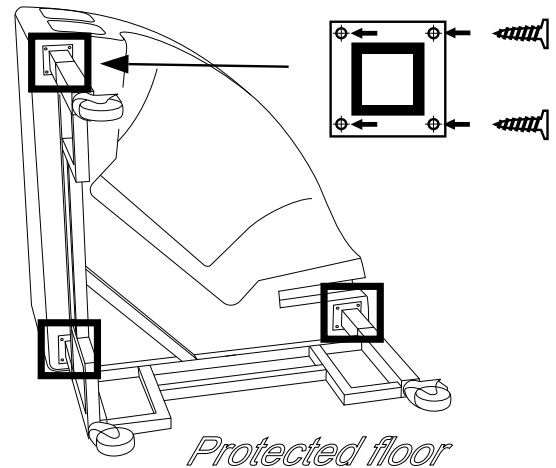

3.4) Fixation: Screw the leg extension onto the tub. **It is strongly advised not to unscrew the bolts to change the height after installation.**

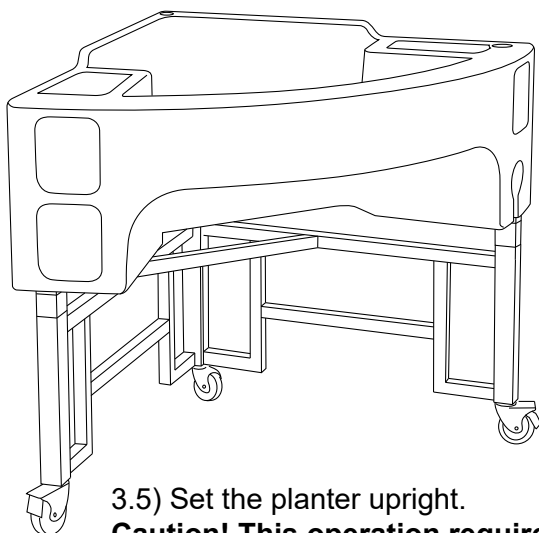

3.5) Set the planter upright.  
**Caution! This operation requires 2 persons.**

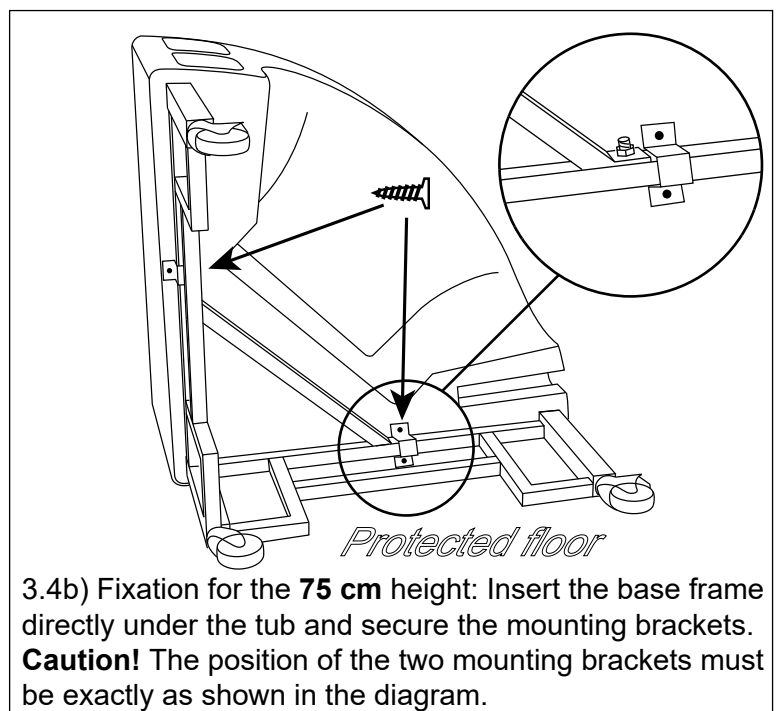

3.4b) Fixation for the **75 cm** height: Insert the base frame directly under the tub and secure the mounting brackets. **Caution! The position of the two mounting brackets must be exactly as shown in the diagram.**

## Dual depth & filling

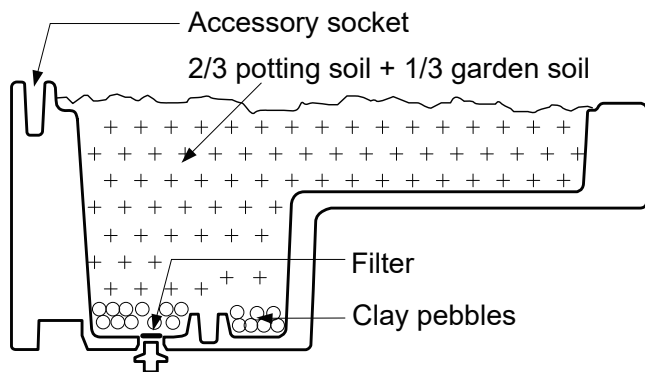

- To ensure good drainage, add a layer of clay pebbles to the bottom of the tub.
- Tub capacity:  
3 L of clay pebbles  
40 L of potting soil  
20 L of garden soil



Scan the QR code  
for the **Planting  
Guide** video

## Filling method

### Filter screen

A filter is generally attached to the drainage hole at the bottom of the tub.

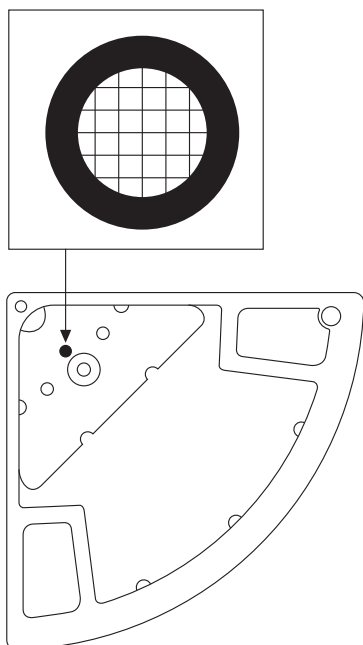

1. Check that the filter is correctly positioned.
2. Connect the drain hose if the gardening is taking place indoors.
3. Place 3 L of clay pebbles at the bottom of the tub (Diagram①)
4. Fill with 40 L of potting soil (Diagram②).
5. Add 20 L of garden soil (Diagram③)
6. Mix the potting soil and garden soil thoroughly (Diagram④).
7. Lightly press the surface with your hands; the fill level should reach the top of the markers.

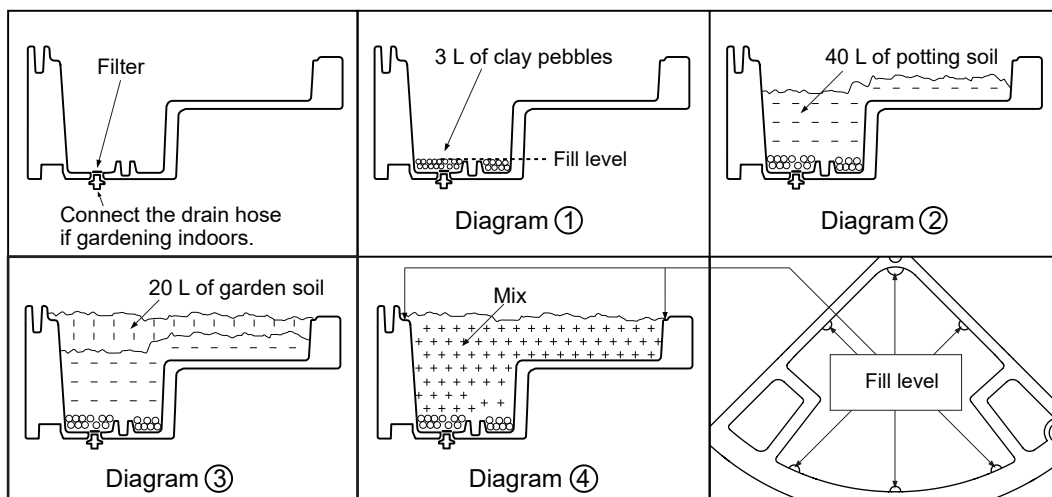

## Drainage system

The filter is integrated into the drainage system to prevent the clay pebbles from blocking the drainage hole.

To continue gardening activities in case of bad weather, the planter can be moved indoors. To prevent water from spilling, connect the drain hose to the adapter under the tub. The plug at the other end of the hose allows you to stop the water flow or drain excess water. A cord is attached to the plug, which can be used to hang the hose on the metal hook installed under the tub.

For permanent outdoor use, to facilitate water drainage, the drain hose can be:

- Not used (Option 1)
- Connected under the tub without the plug (Option 2)

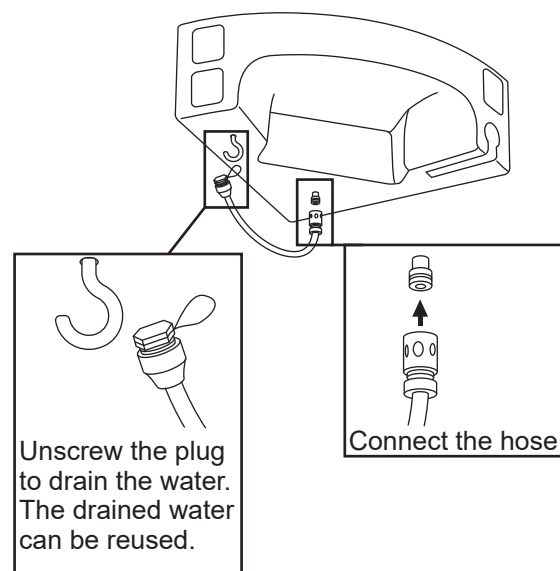

## Maximum load capacity

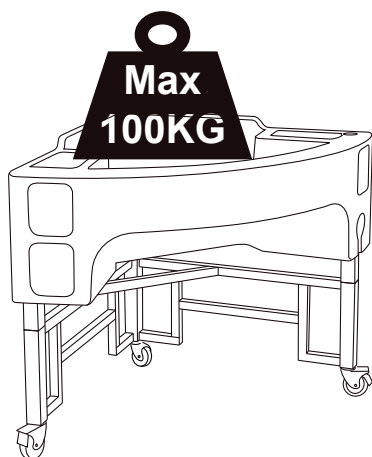

## Lifting the planter

When lifting the planter over an obstacle such as a step, hold the metal bars instead of the plastic tub.

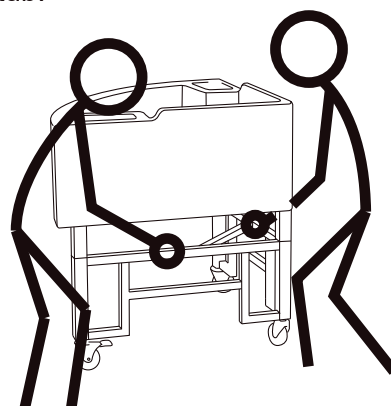

## Cleaning

- Clean simply with dish soap.
- As the planter is in direct contact with the user, it is recommended to keep it clean, especially when used outdoors.

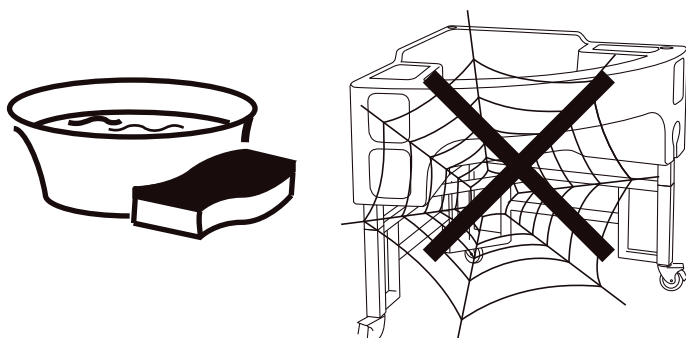

## Lock the casters

- Once the planter is in position, lock the caster brakes.
- Use your foot, not your hand.
- When moving the planter, first remember to unlock the brakes.

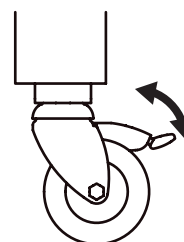

## Important

This is not the water reservoir inlet.  
Do not pour water into it.

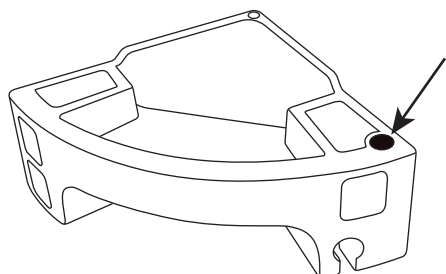

## Digital documents



On this page **[verdurable.fr/cdsboutique](http://verdurable.fr/cdsboutique)**, find all your digital documents, videos, and PDFs to easily start your therapeutic garden:

- Guide d'installation
- Thèmes de jardin réalisables
- Démarrage de la plantation
- Check-list avant l'atelier

...

## Follow our news



[www.verdurable.fr](http://www.verdurable.fr)



<https://www.facebook.com/verdurable>